

Virginia Currer Marine Ltd

Inland Waterway Specialists

Delta House Delta Way Thorpe Egham Surrey TW20 8RX

Tel: 01784 432111

Fax: 01784 432777

Mob: 07860 480079

Email: jc@vcmarine.co.uk

Web: www.vcmarine.co.uk

NORTHERN SOUL

£47,000

General.

Builder: Peerless Boats **Type:** Traditional Stern
Fitted: Braidbar Boats & Macclesfield Canal Centre **Year:** 2003/4
Length: 57ft (17.4m) **Beam:** 6ft 10ins (2.1m) **Draught:** c1ft 9in (.6m)
Lying: High Line Yachting, Iver
BW no: 509760 **CIN No:** N/a – 5 year exemption **BSC to:** Feb 2012

History

The vessel is being sold by the first owner who purchased in 2003 as a shell and then project managed the completion in 2004. Steelwork by Peerless Boats, interior fit part by Braidbar and part by Macclesfield Canal Centre and paintwork by Andy Russell.

Hull & Exterior.

Material / build: All steel. **Thicknesses:** Not known



Exterior: Black bitumen painted hull to rubbing band. Matt black from rubbing band through side decks, with non slip finish to side decks. Cabin sides in dark green with cream coachline and decorative motifs by windows. The aft panel is finished with a red panel, cream coachline and scumble surround. The panel is signwritten with the vessel's name. Handrails picked out in maroon. Roof in old finished red, with the aft section in planked scumble finish with central diamond decoration.

Windows: Anodised aluminium top hopper opening, 4 to port and two to starboard with additional fixed brass trimmed portholes aft. Two pairs of opening side doors to starboard.

Forward well: Rope fender. Steel cants. 'T' stud. Gas locker containing 2 x 13kg gas bottles. Varnished timber glazed cratch board with overall cover in green PVC, zip up side entry panels. Self draining steel well deck with stainless steel water tank below. Two central half glazed varnished timber doors to accommodation.

Roof: Integral steel handrails. 5 brass mushroom vents. Houdini style opening hatch. Motorised satellite dish. Flue for solid fuel stove. Hinged hatches over side entry doors. Brass pole and plank holder. Sliding hatch over access aft.

Northern Soul continued

Aft deck: Rope fender, 2 mooring dollies, steel cants, diesel filler. Tiller steering. Self draining deck. Two central timber lined steel doors to accommodation.

Mechanical & Electrical.

Engine: Beta 43 with twin alternators, hospital silencer and Crowther propeller
Gearbox: PRM Delta hydraulic
Last service: Not known *Control:* Single lever
Cooling: Skin tank *Calorifier feed:* Yes
Bowthruster: No

Weed hatch: Quick release *Stern gland greaser:* Remote
Bilge pump: 12v

Batteries: 12v *Domestic:* 3 *Engine:* 1
240v: Yes *Inverter:* Stirling 3000w full sine wave *Charger:* No *Generator:* No

Instrument panel: Comprises Beta unit with key start, oil pressure gauge, engine temperature gauge, voltmeter, tachometer with engine hour meter reading 1564 hours, and usual warning lights

Interior.

Lining - floor to gunwale: Mid blue carpeting
Lining - gunwale to ceiling: Solid oak satin varnished tongue with matching trim
Lining - ceiling: Ditto
Bulkheads: Matt varnished oak faced panelling
Curtains: Beige lined on brass rails
Flooring: Timber laminate throughout, except bathroom which has grey tile effect vinyl
Lighting: Inset 12v halogen
Cabin heating: Eberspacher diesel fired and Morso solid fuel stove with back boiler.
Insulation: Proprietary block foam
Water heating: Calorifier from engine, Eberspacher and 240v immersion heater
Headroom: 6ft 3in

ACCOMMODATION (From aft)

Cabin Arrangement: Engine room / Double cabin / Bathroom / Study / Galley / Saloon

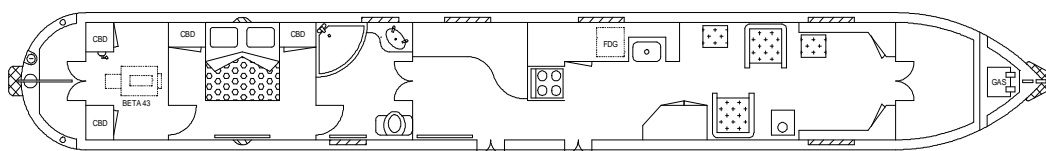

Berth arrangement: 2 berth - fixed double in own cabin

Northern Soul continued

Cabin 1: Engine room. The engine room is fully lined and the engine enclosed. Servis 'Easy Logic' washer drier. Door to starboard with step down into ...

Cabin 2: Double Cabin. The double berth is crossways with 5ft wide custom made interior sprung split mattresses. Over the head of the bed are high level cupboard units with reading lights below. Either side are high level cupboards with half height hanging and storage below. Radiator on hull side. Door to starboard leads forward into ...



Cabin 3: Bathroom. The bathroom occupies the full width of the vessel comprising glass enclosed corner shower with thermostatic mixer, white china hand basin inset into varnished timber surface with cupboard and open storage below. Thetford cassette electric flush toilet. Mirror on bulkhead. Radiator on hull side. Two central varnished timber doors lead forward into ...



Cabin 4: Study. To port is an 'L' shaped section of varnished timber worktop with cupboard below. Opening side doors opposite. Radiator on hull side. Doorway to starboard leads forward into ...

Cabin 5: Galley. The galley is 'L' shaped to port. Varnished solid timber work tops over varnished timber cupboards below. Against the aft bulkhead is a full size 4 burner cooker in black and silver. Below work surface is a Lec 240v refrigerator. White china 'butler' style sink unit with brass effect antique style mixer taps. Opening side doors to starboard. To starboard partially extending into the saloon is a matching section of work surface with cupboards and drawers below. Over this at high level is a glass fronted display cabinet. The galley is open plan to

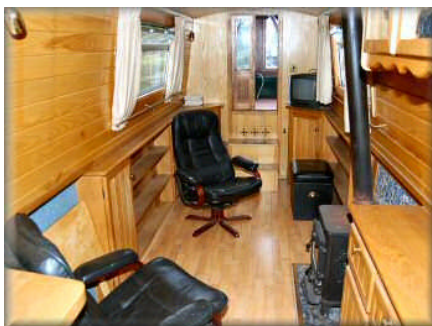

Cabin 5: Saloon. The saloon is designed to take free standing furniture currently comprising 2 blacking rocking armchairs and matching foot stools. The Morso solid fuel stove is mounted on a tiled timber trimmed hearth with matching rear. To port and starboard are under gunnel shelving units leading up to under gunnel angled storage cupboards against the forward bulkhead. That starboard house satellite decoder, radio

/ DVD player and satellite control. Phillips television. Two steps incorporating storage up to forward well.

This boat has been cleared and will be sold as viewed.

Northern Soul continued

GENERAL

Berth transferable: Possible cruising berth by arrangement

Sale type: Private

Viewing: High Line Yachting, Mansion Lane, Iver, SL0 9RG
9am to 6pm Tuesday to Saturday, 11am to 5pm Sunday, closed Monday.

PLEASE NOTE

In this case we are acting as Brokers only.

Whilst every care has been taken in their preparation, the correctness of these particulars is not guaranteed.

The particulars are intended only as a guide and they do not constitute a term of any contract.

A prospective buyer is strongly advised to check the particulars and where appropriate at his own expense to employ a qualified Marine Surveyor to carry out a survey and / or to have an engine trial conducted which if conducted by us shall not imply any liability for such engine on our part.

The Vendor is not selling in the course of a business.

All sales subject to contract. No guarantee is given or implied as to the condition or legal title.

No appliances or systems have been tested. All measurements stated are approximate.

© Virginia Currer Marine Ltd 2010