

Virginia Currer Marine Ltd

Inland Waterway Specialists

Delta House Delta Way Thorpe Egham Surrey TW20 8RX

Tel: 01784 432111

Fax: 01784 432777

Mob: 07860 480079

Email: jc@vcmarine.co.uk

Web: www.vcmarine.co.uk

AVONTURIER [DRAFT]

£135,000

General.

Builder: **Steelcraft**

Type: Replica Dutch Barge

Fitted: Wyvern Shipping of Leighton Buzzard Year: 1991 (completed 1992)

Length: 66ft (20.1m)

Beam: 13ft 6ins (2.1m) Draught: c1ft 9in (.6m)

Lying: Port Solent,

BW no: 502686 (not licensed)

SSR no: 46033

CIN No: N/a

BSC to: None

History

The vessel was purchased via ourselves in June 2002, having been previously sold by ourselves in 1998. Since then she has cruised in Europe and the UK coastal waters and was last out of the water in 2008, when the hull was laced and new anodes were fitted. The vessel is for sale as the owner is relocating abroad.

Hull & Exterior.

Material / build: All steel. Thicknesses: 20 / 8 / 6 / 5mm



Exterior: Black bitumen painted hull to rubbing band. Bright red sheerline and bulwarks in gloss black. Side decks in non slip pale blue. Cabin sides and superstructure in white. The name is sgnwritten on the bow and stern.

Windows: Brass anodised aluminium arched top with top hopper opening and some sliding, 6 to starboard and 7 to port. Additional opening side

doors to port.

Forward well: Raised bulwarks with elevated mooring bits. Manual anchor winch with hawse pipe and admiralty style anchor.

Roof: Ventilation way of stainless steel Tannoy vents and Houdini style opening hatch. Light / flag mast forward. Tubular steel handrails. Hinged hatch over side doors. Two mounting pints for winch mechanism enabling a dinghy to be lifted. The wheel house is of varnished hardwood, fully glazed, and is demountable.

Aft deck: Flat aft deck with recessed hatch giving access to weed hatch and rudder assembly.

Avonturier continued

Mechanical & Electrical.

Engine: Ford Lehman 2725E 6cyl 135hp normally aspirated
Gearbox: PRM hydraulic
Last service: Autumn 2008
Cooling: Indirect raw water
Bowthruster: 24v Slipner electric
Control: Single lever
Calorifier feed: Yes
Weed hatch: Quick release
Stern gland greaser: Screw down
Bilge pump: 12v
Batteries: 12v and 24v
Domestic: 8 x 6v providing 2 x 12v banks
Engine: 2 x 12v
Generator: 1 x 12v
240v: Yes
Inverter: Atlas Combi 1500w inverter / charger
Charger: Atlas combi
Generator: GNM 9.75kva diesel, water cooled

Instrument panel: Vetus unit with tachometer with engine hour meter reading 913 hours, oil pressure gauge, engine temperature gauge, voltmeter, rudder position indicator, press button start and stop, and usual warning lights including audible dry exhaust alarm.

Navigation equipment: Ritchie compass, Compact marine VHF, NASA echo sounder, Raytheon chart plotter and radar.

Interior.

Lining - floor to gunwale: Oak faced panelling with contrasting mahogany trim.
Lining - gunwale to ceiling: As above
Lining - ceiling: As above
Bulkheads: As above
Curtains: Beige curtains on brass rails
Flooring: Loop pile beige carpeting throughout
Lighting: Combination of inset fluorescent and wall lamps
Cabin heating Mikuni diesel with radiators
Insulation: Polystyrene
Water heating Calorifier heated by Mikuni, engine, and 240v immersion
Headroom: 6ft 6in

ACCOMMODATION (From aft)

Cabin Arrangement: Wheelhouse / Dining area / Galley / Saloon / WC / Double cabin 2 / Bathroom / Twin Cabin / En suite master double cabin

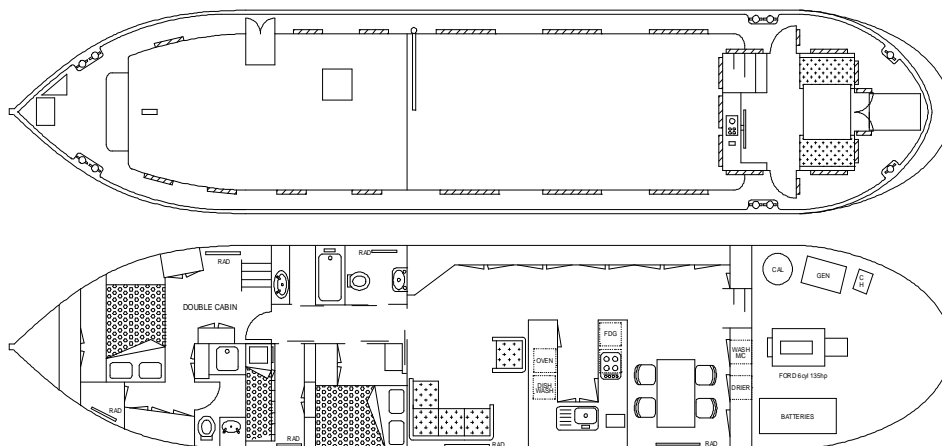

Berth arrangement: 8 berth, two double cabins and twin bunk cabin and convertible double in wheelhouse

Avonturier continued.....



Cabin 1: Wheelhouse. The upper timber section is demountable. Entry doors to both sides and to rear. At the aft end is a Pullman style dinette unit, which also acts a day saloon seating. This unit can convert to a double berth if required. The helm position is central. Radiator on forward bulkhead. Steps to starboard lead down to accommodation.

Cabin 2: Dining area. Along the aft bulkhead is built in storage comprising high and low level cupboards, and display units. This unit also houses a washing machine and tumble drier. Radiator on hull side. Timber dining table with 4 chairs. The dining area is open plan to ...

Cabin 3: Galley. The galley is 'U' shaped and to port. Pale granite effect laminate timber trimmed work surface with varnished timber cupboards and drawers below. Inset is a Parkinson Cowan Module 4 four burner hob in beige, as is a composite material sink and drainer unit. Below work surface a Parkinson Cowan Module 4 grill and oven. Favorit dishwasher and Zanussi 240v fridge. Microwave. The galley is open plan to ...



Cabin 4: Saloon. The saloon currently comprises free standing furniture, with brown suede effect easy chair and matching 'L' shaped settee unit. Under gunnel shelving. 240v radiant heater. To doors slightly offset to starboard continues forward into passageway with to starboard sliding door into...

Cabin 5: WC Compartment. Sani Marin remote pump out toilet. Mirror doored bathroom cabinet. White china hand basin with tiled splash back and mirror over. Radiator on hull side. Razor socket. Further sliding door off passageway into

Cabin 6: Double cabin 2. The double bed is lengthways c. 6ft 3in x 4ft with drawer storage below. Shelf over foot of bed. Corner mounted vanity unity with drawer below. Double fronted wardrobe against forward bulkhead with half height hanging and shelving below. Further sliding door of passageway into



Avonturier continued.....

Cabin



7: Twin bunk cabin. By the aft bulkhead the lower bunk is c. 6ft 5in x 2ft 2in with drawer storage below. , and the upper is c. 5ft 7in x 2ft 2in. Against the forward bulkhead is further cupboard and shelf storage. Radiator on hull side. Further sliding door leads into

Cabin

8: Bathroom. Hip bath with brass effect Mira shower head. The bath are is full tile lined. Beige china hand basin inset into granite effect laminate work surface, with cupboards below. Mirror over. Radiator on hull side. Passageway continues forward to door into

Cabin 9: Master double cabin. Steps to starboard lead up to opening side doors. Under gunnel storage cupboards. The double is against the forward bulkhead with interior sprung mattress c.6ft 4in x 5ft. Shelving around head and side of bed. To port is further under gunnel storage. At the foot of the bed is a half height cupboard with hanging rail. Further two doored wardrobe with high level shelf, half height hanging, and shelving below. Door off bedroom leads into ...



Cabin 10: En suite bathroom. Fully tile glass doored shower enclosure with MIRA shower fitting. Sani Marin remote pump out toilet. White china band basin inset into granite effect laminate work surface with storage below. Mirror on bulkhead. Radiator on hull side.

This boat has not been cleared and personal possessions will be removed prior to sale.

GENERAL

Berth transferable: Possible cruising berth by arrangement

Sale type: Private

Viewing: By appointment.

PLEASE NOTE

In this case we are acting as Brokers only.

Whilst every care has been taken in their preparation, the correctness of these particulars is not guaranteed.

The particulars are intended only as a guide and they do not constitute a term of any contract.

A prospective buyer is strongly advised to check the particulars and where appropriate at his own expense to employ a qualified Marine Surveyor to carry out a survey and / or to have an engine trial conducted which if conducted by us shall not imply any liability for such engine on our part.

The Vendor is not selling in the course of a business.

All sales subject to contract. No guarantee is given or implied as to the condition or legal title.

No appliances or systems have been tested. All measurements stated are approximate.