

# Virginia Currer Marine Ltd

## Inland Waterway Specialists

Delta House Delta Way Thorpe Egham Surrey TW20 8RX

Tel: 01784 432111

Fax: 01784 432777

Mob: 07860 480079

Email: [jc@vcmarine.co.uk](mailto:jc@vcmarine.co.uk)

Web: [www.vcmarine.co.uk](http://www.vcmarine.co.uk)

---

## TALISMAN

**£137,500**

---

### General.

*Builder:* **RLL Boatbuilders**                      *Type:* Replica Dutch Barge  
*Fitted:* Devizes Narrowboat Builders      *Year:* 2004  
*Length:* 58ft (17.7m)                      *Beam:* 12ft (3.6m)                      *Draught:* c2ft 6in (.7m)  
*Lying:* nr Hungerford, Kennet & Avon Canal  
*BW no:* 509426                      *CIN No:* GB – DNB0802804WB      *BSC:* June 2012

---

### History

The vessel is being sold by the original owners, and a VAT history can be provided. The vessel was last out of the water in 2007, at which time the hull was blacked and the anodes were found to be serviceable.

---

### Hull & Exterior.

*Material / build:* All steel.      Thicknesses: 10 / 6 / 4mm

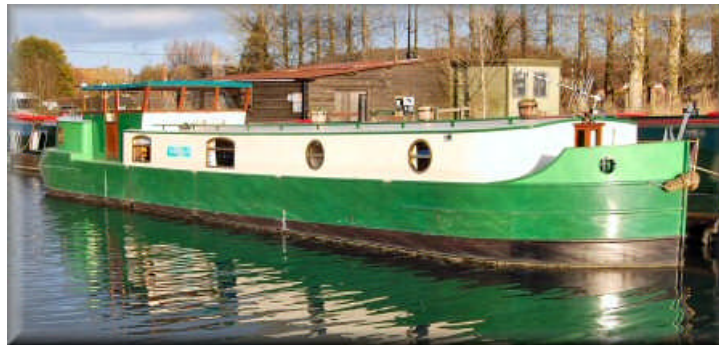

*Exterior:* Black bitumen painted hull to lower rubbing band. Mid green from lower rubbing band to remaining hull sides and side decks. Superstructure in cream, with the handrails picked out in green.

*Windows:* Two brass anodised aluminium 'arch top' top opening, and three large opening port holes each side.

*Forward well:* Raised bulwarks. Two mooring bits. Flat foredeck with inset bolted down access plate to water tank below. Two central glazed varnished timber opening windows providing an escape hatch.

*Roof:* Tubular steel handrails. Three 'Tannoy' vents. Flue for solid fuel stove. The lower section of the wheelhouse is in steel, with the upper being fully glazed in varnished timber, and demountable.

*Aft deck:* Two mooring bits. Two central glazed varnished timber opening windows providing an escape hatch.

Talisman continued .....

---

### **Mechanical & Electrical.**

Engine: Beta Kubota 5cyl BF2803 62hp      Gearbox: PRM 260 hydraulic  
Last service: Serviced every 200 hours      Control: Single lever  
Cooling: Skin tank      Calorifier feed: Yes  
Bowthruster: No  
Weed hatch: Quick release      Stern gland greaser: Remote  
Bilge pump: 12v

Batteries: 12v      Domestic: 4      Engine: 1  
240v: Yes      Inverter: Small inverter for TV and cooker      Charger: No  
Generator: Engine mounted 3,5kVA Travelpack

Instrument panel: Beta unit with key start, press button stop, tachometer with engine hour meter reading 3,403hours and usual warning lights

---

### **Interior.**

Lining - floor to gunwale: Varnished ash veneered panelling with matching trim.  
Lining - gunwale to ceiling: As above  
Lining - ceiling: As above  
Bulkheads: As above

Curtains: Lined pale patterned  
Flooring: Blue pile carpeting to bedroom, patterned blue carpeting to saloon, and tile effect vinyl to galley  
Lighting: 12v halogen

Cabin heating Webasto diesel fired central heating with radiators, and Morso solid fuel stove with back boiler and further radiators in saloon.

Insulation: Rockwool  
Water heating Calorifier heated from engine, central heating and 240v immersion

Headroom: 6ft 11in

---

### **ACCOMMODATION** (From aft)

Cabin Arrangement: Guest cabin (en suite) / Wheelhouse / galley / Saloon / Bathroom / Master cabin

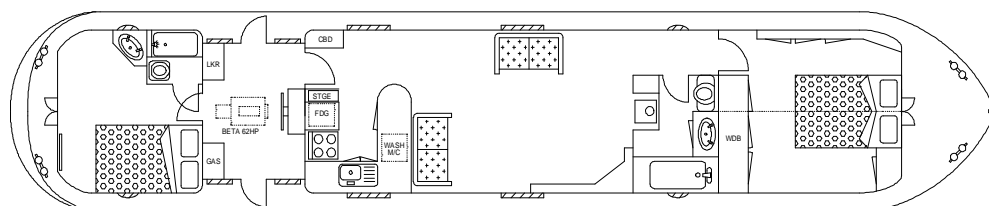

Berth arrangement: 6 - fixed double in guest cabin, freestanding double in master cabin, and convertible double in saloon

Talisman continued .....

**Cabin 1:** Guest cabin. Door gives access to steps down from wheelhouse into aft cabin. The double berth in lengthways to starboard with interior sprung mattress c. 6ft 3in x 4ft. Storage below bed. Beige hand basin inset into angled varnished timber cupboard unit, with mirror over. Towel rail. Radiator on aft bulkhead. To port a door enters the en suite bathroom comprising step in fully tiled shower unit with shower curtain and Thetford Cassette manual flush toilet. Against the aft bulkhead is a step up to opening rear windows. The step houses the weed hatch. Access through rear bulkhead to hydraulic steering gear, with emergency manual tiller arrangement.



**Cabin 2:** Wheelhouse. Entered from either side. Against the aft bulkhead are two seats / lockers, one containing solid fuel, and the other being a gas locker with 2 x 13kg gas bottles. Central helm position with wheel steering. Door to port opens onto steps down to .....

**Cabin 3:** Galley. The galley is 'U' shaped and to starboard. Black marble effect timber trimmed work surface, with varnished timber cupboards below. Against the aft bulkhead is a full height cupboard unit with slide out storage. Stoves Newhome 4 burner gas cooker with grill and oven. Hand painted canal scene in tiles forms a splashback. Shoreline 12v refrigerator below work surface. High level storage and plate rack. To the side is an inset stainless steel single bowl sink and drainer unit with mixer tap. Below the forward section of work surface is a Tricity Bendix 240v automatic washing machine. Further high level storage cupboards. Opposite the galley are further gunnel height storage cupboards. The galley is open plan to.....



**Cabin**



**4:** Saloon. The saloon is designed to take freestanding furniture, currently comprising two large settee units either of which can be converted to a double berth. Built into the forward bulkhead is a 'fireplace' with tiled timber trimmed hearth, and varnished timber sides and mantle, and Morso solid fuel stove mounted within. To starboard is a built in low angled varnished timber

cupboard unit, extending into open shelving. Door to port leads forward with door off into .....

Talisman continued .....

**Cabin 5:** Bathroom.  $\frac{3}{4}$  sized bath with fully tiled surrounds. Multi fold glass shower screen. White china hand basin inset into tiled timber trimmed surface with cupboard below. Sealand pump out toilet, fitted with its own discharge pump. Mirror on bulkhead. Against the aft bulkhead is full height cupboard acting as an airing cupboard. Passageway continues forward to door into .....



**Cabin 5:** Master cabin. The freestanding double bed is mounted centrally against the forward bulkhead. Two bedhead reading lights. Bedside cabinet. Against the aft bulkhead is a full height wardrobe unit with mirrored doors. To port along the length of the cabin are low level under gunnel storage cupboards.

This boat has not been cleared and personal possessions will be removed prior to sale.

---

#### **GENERAL**

Berth transferable: No      Sale type: Private      Viewing: By appointment.

#### **PLEASE NOTE**

*In this case we are acting as Brokers only.*

*Whilst every care has been taken in their preparation, the correctness of these particulars is not guaranteed.*

*The particulars are intended only as a guide and they do not constitute a term of any contract.*

*A prospective buyer is strongly advised to check the particulars and where appropriate at his own expense to employ a qualified Marine Surveyor to carry out a survey and / or to have an engine trial conducted which if conducted by us shall not imply any liability for such engine on our part.*

*The Vendor is not selling in the course of a business.*

*All sales subject to contract. No guarantee is given or implied as to the condition or legal title.*

*No appliances or systems have been tested. All measurements stated are approximate.*